

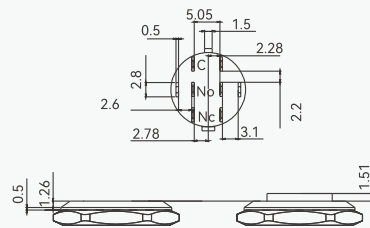

金属按钮开关 /Metal push button switch

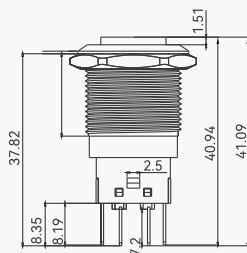

外形尺寸 /Outline size

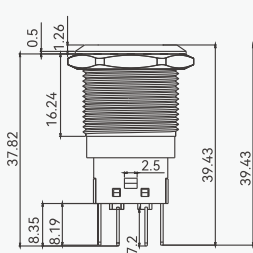

注: 可选按钮开孔直径 $\phi 19$ 、 22 、 25 mm
Note: Optional button opening diameter $\phi 19$ 、 22 、 25 mm

金属按钮开关 /Metal push button switch



外形尺寸 /Outline size

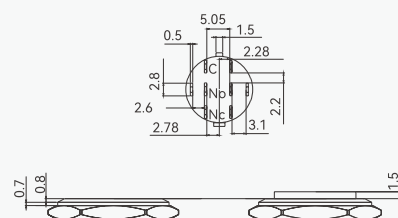
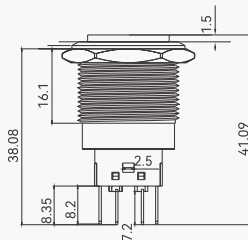
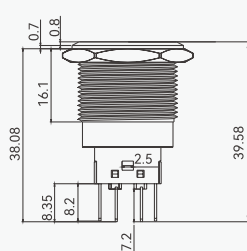

注: 可选按钮开孔直径 φ16、19、22、25mm
Note: Optional button opening diameter φ19、22、25mm

金属按钮开关 /Metal push button switch



更多产品信息请详询本公司!
More Product Information Please contact us for details!

外形尺寸 /Outline size

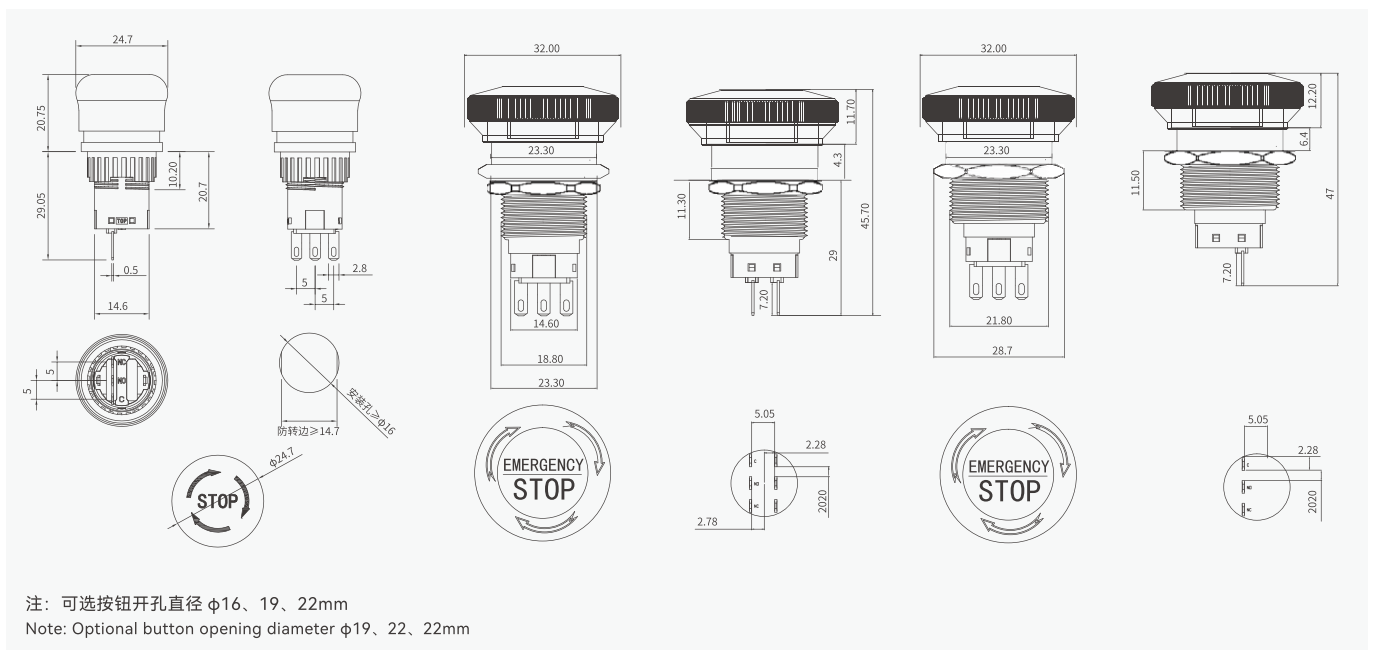

A7 new Metal push button switch



A2 Series

防水等级≤IP65
Waterproof class ≤IP65

相较于新款，体积更大
Compared with the new model, the volume is larger

自复/自锁功能长度一致
the length of momentary/latching model
is the same

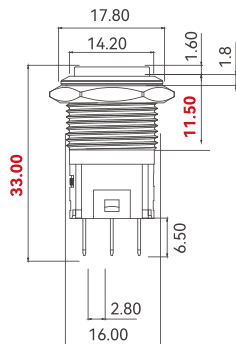

A7 Series

防水等级IP65/IP67，适应更多环境
Waterproof rating **IP65/IP67**, suitable for
more environments

壳体**15mm**，空间利用更充分
housing length **15mm**, fully utilize the space

自复/自锁功能长度一致
the length of momentary/latching model
is the same

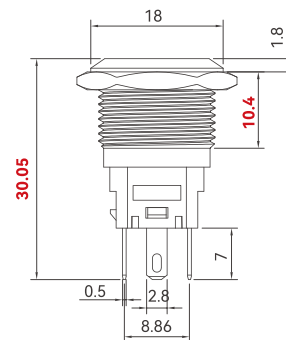

产品型号
Product model

防水等级
Waterproof class

体积
Volume

电气性能一致
Consistent electrical performance

外形尺寸
Overall dimension



A2 SERIES

A2 系列按钮开关

A2 series push button switch

金属外壳，防止使用过程中各种撞击产生的开关失效现象。
按钮表面可订制各种图案以区分开关功能。
稍短的体积可满足更狭小的安装空间。

Metal shell to prevent switch failure caused by various impacts during use.
The button surface can be customized with various patterns to distinguish the switch function.
The slightly shorter volume allows for a smaller installation space.



抗震耐摔
shock-resistant



防水防尘
Waterproof and dustproof



安全实用
Safe and practical



品质保证
Quality assurance

型号说明 / Model description

企业代号 Business code	外壳材质 Housing material	安装孔尺寸 Mounting hole size		系列号 Serial number	触点结构 Contact structure		操作类型 Operation mode		带灯类型 With LED		头部形状 Head shape		接线类型 Wiring type		带灯颜色 LED color		带灯部分电压 LED voltage			
		12	Φ12mm		10	1NO	D	信号 指示灯 Signal indicator	D	面部大范围 Entire urface	P	平头 Flat head	Q	焊接脚 Welding pins	R	红 Red	AC/DC 3V			
H	铜镀镍 Nickel-plated brass	16	Φ16mm	A2	11	1NO 1NC	Z	自锁 Latching	D1	点灯 Dot	T	高平头 High flat head	G	绿 Green	AC/DC 6V					
		19	Φ19mm		22	2NO 2NC									D2	环形灯 Ring	Y	黄 Yellow	AC/DC 24V	
		22	Φ22mm		无 Momentary														D3	电源标识灯 Power icon
JA	铝氧化 Aluminum oxide	25	Φ25mm	JG	不锈钢 Stainless steel	40	Φ40mm	D4	电源标识灯 加环形灯 Power icon with ring	WT	白 White	AC/DC 110V								
L	塑料 Plastics	AC/DC 220V																		

注：请仔细阅读产品具体说明后，根据不同符号在该表中选取相应代号。
定制特殊图案请与销售人员沟通确认。
外壳材料：黄铜镀铬、黄铜镀镍、不锈钢、铝氧化（彩色），下单请注明外壳材料，HJ □ 16A 默认为黄铜镀铬外壳，其余默认为不锈钢外壳。

Note: Please read the specific description of the product carefully, and select the corresponding code in the table according to different symbols.
Customize special patterns, please communicate with sales staff to confirm.
Housing material: Chrome plated brass, brass nickel plated, stainless steel, aluminum oxidation (color), please indicate the shell material when placing an order, HJ □ 16A defaults to Chrome plated brass shell, and the rest defaults to stainless steel shell.

概述 / Summary

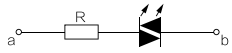
安装孔尺寸 Mounting hole size	Φ12、16、19、22、25、30、40mm
开关额定值 Switch rating	12mm 电流 2A、其他 5A 12mm current 2A, other 5A
开关组合 Switch combinations	1NO 1NC / 2NO 2NC
操作类型 Operation mode	自复式 / 自锁式 Momentary/Latching
头部形状 Head shape	平圆形 / 高圆形 Flat head / High flat head
外壳材料 Housing material	不锈钢 / 铝（氧化） 黄铜镀铬 Ring light/power indicator light/Chrome plated brass
带灯方式 With LED	环形灯 / 电源标灯 Ring /power indicator light
防护等级 Protection level	IP65 IK09
灯珠类型 LED type	双向 LED 灯珠（交直流通用）可定制三色或双色 Two way LED beads (AC and DC universal) Three or two colors can be customized
额定电流 I _e Rated current I _e	5~48V 约 15mA; 110~250V 约 2mA 5~48V about 15mA; 110~250V about 2mA
降压方式 Voltage reduction method	内置电阻 Built-in resistance
灯珠等效 Beads equivalent	采用交直流通用的 LED 灯珠，接线端子无正负极区分灯珠内置保护电阻，不需外接。 Using AC and DC universal LED lamp beads, the terminal has no positive and negative poles to distinguish the built-in protection resistance of the lamp beads, and does not need to be connected.
电路 Circuit	

开关结构说明 / Switch structure description

型式 / Type	示意图 / Schematic diagram	符号 / Symbol
C		

引脚说明 / Pin description

最多可配置两组开关。
C、NO、NC 和 C、NO、NC 分别为一组开关；C 脚为公用脚，NO 脚为常开脚，NC 脚为常闭脚；+、- 脚为灯珠引脚，常规灯珠配置无正负极区分。灯珠与开关相对独立，可通过开关或外围电路控制灯珠状态。

Up to two sets of switches can be configured.
C, NO, NC and C, NO, NC are a set of switches; C foot is common foot, NO foot is normally open foot, NC foot is normally closed foot; +, - pins are lamp bead pins, and conventional lamp bead configuration has no positive and negative polar distinction. The lamp beads are relatively independent of the switch, and the lamp bead status can be controlled by the switch or peripheral circuit. Lamp bead terminals

性能特征 / Performance characteristics

产品规格 Product specifications	HJ □ □ A2- □ ■ / □ / Q	机械寿命 Mechanical life	20 万次以上 More than 200,000 times		
绝缘强度 Dielectric strength	1500VAC	电气寿命 Electrical life	10 万次以上 More than 100,000 times		
绝缘电阻 Insulation resistance	≥ 1000MΩ	面板厚度 Panel thickness	1~10mm		
接触电阻 Contact resistance	≤ 50mΩ	螺母扭矩 Nut torque	5~14Nm		
开关规格 Switch specifications	3A/250V	操作压力 Operating pressure	3N~5N		
尾部配置 Bottom configuration	接线插片 (2.8×6.5mm) Wiring pins (2.8×6.5mm)	操作行程 Operation travel	约 3.1mm About 3.1mm		
头部形状 Head shape	高平头 / 平头 High flat head/flat head	防护等级 Protection level	IP65 IK09		
环境温度 Ambient temperature	- 20°C ~ +55°C				
材料 Material	触点 Contact	纯银镀金 Sterling silver gilded	带灯部分参数 LED parameter	灯珠类型 LED type	双向 LED 灯珠 (交直流通用) Two way LED beads (AC and DC universal)
	按键 Button	不锈钢 / 铜镀镍 / 铝 (氧化) Stainless steel / Nickel-plated brass / aluminum (oxidized)		额定电压 Ue Rated voltage Ue	3V / 6V / 12V / 24V / 36V / 48V / 110V / 220V
	外壳 Housing	不锈钢 / 铜镀镍 / 铝 (氧化) Stainless steel / Nickel-plated brass / aluminum (oxidized)		灯珠颜色 LED color	R Y G B W
	基座 Pedestal	PA		灯珠寿命 LED life	40000 小时 40,000 hours
RoHS	可定制 Customizable				

金属按钮开关 /Metal push button switch



外形尺寸 /Outline size

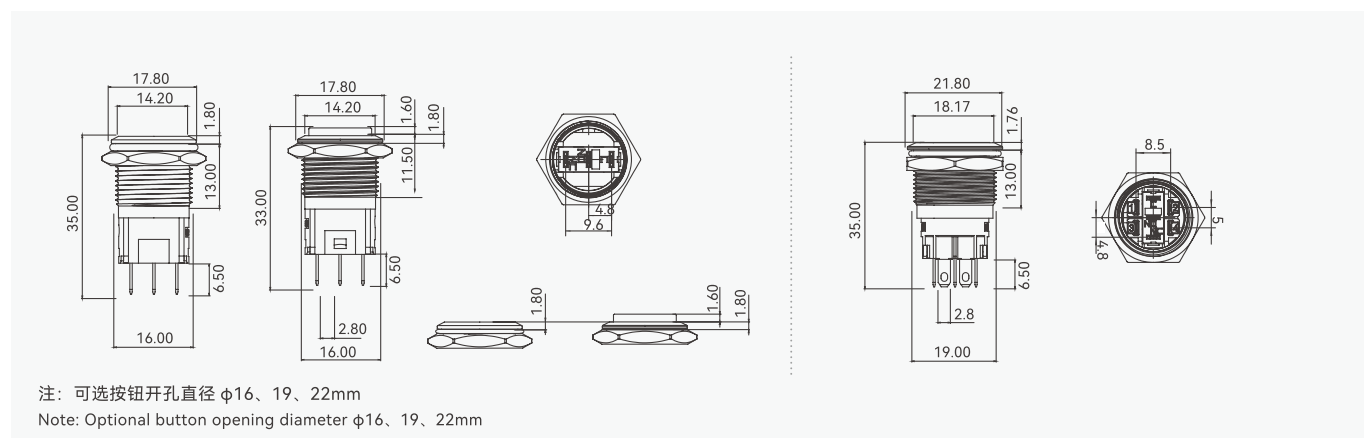

金属按钮开关 /Metal push button switch



外形尺寸 /Outline size

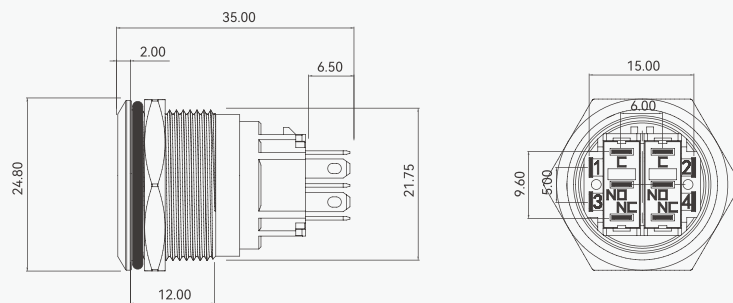

注：可选按钮开孔直径 φ16、19、22mm
Note: Optional button opening diameter φ16、19、22mm



56A SERIES

56A 系列按钮开关

56A series push button switch

更大的按键面可满足各种售卖机、取号机的使用要求。

按钮表面可订制各种图案以区分开关功能。

金属外壳使设备的外观更显质感。

防水 IP65/IP67，可直接在户外场景使用。

The larger key surface can meet the requirements of various vending machines and number machines.

The button surface can be customized with various patterns to distinguish the switch function.

The metal casing gives the appearance of the device more texture.

Waterproof IP65/IP67, can be used directly in outdoor scenes.



抗震耐摔
shock-resistant



防水防尘
Waterproof and dustproof



安全实用
Safe and practical



品质保证
Quality assurance



型号说明 / Model description

企业代号 Business code	外壳材质 Housing material	安装孔尺寸 Mounting hole size		系列号 Serial number	触点结构 Contact structure		操作类型 Operation mode	带灯类型 With LED	头部形状 Head shape	接线类型 Wiring type	带灯颜色 LED color	带灯部分电压 LED voltage
H	JG 不锈钢 Stainless steel	56	Φ56mm	A	11	1NO 1NC	D	D	P	Q	R	AC/DC 3V
					22	2NO 2NC	无	面部大范围 Entire surface	平头 Flat head	焊接脚 Welding pins	G	AC/DC 6V
							自复 Momentary				Y	AC/DC 12V
											B	AC/DC 24V
											WT	AC/DC 36V
												AC/DC 48V
												AC/DC 110V
												AC/DC 220V

注：请仔细阅读产品具体说明后，根据不同符号在该表中选取相应代号。

定制特殊图案请与销售人员沟通确认。

外壳材料：黄铜镀铬、黄铜镀镍、不锈钢、铝氧化（彩色），下单请注明外壳材料，HJ □ 16A 默认为黄铜镀铬外壳，其余默认为不锈钢外壳。

Note: Please read the specific description of the product carefully, and select the corresponding code in the table according to different symbols.

Customize special patterns, please communicate with sales staff to confirm.

Housing material: Chrome plated brass, brass nickel plated, stainless steel, aluminum oxidation (color), please indicate the shell material when placing an order, HJ □ 16A defaults to Chrome plated brass shell, and the rest defaults to stainless steel Housing.

概述 / Summary

安装孔尺寸 Mounting hole size	Φ56mm
开关额定值 Switch rating	3A/250V
开关组合 Switch combinations	1NO 1NC / 2NO 2NC
操作类型 Operation mode	自复式 / 自锁式 Momentary/Latching
头部形状 Head shape	平圆形 Flat head
外壳材料 Housing material	不锈钢 / 铝 (氧化) / 黄铜镀铬 Stainless steel / Aluminum (oxidized) / Chrome plated brass
带灯方式 With LED	环形灯 / 电源标灯 Ring / power indicator light
防护等级 Protection level	IP65 IK09
灯珠类型 LED type	双向 LED 灯珠 (交直流通用) Two way LED beads (AC and DC universal)
额定电流 I _e Rated current I _e	5~48V 约 90mA; 110~250V 约 15mA 5~48V about 90mA; 110~250V about 15mA
降压方式 Voltage reduction method	内置电阻 Built-in resistance
灯珠等效 Beads equivalent	采用交直流通用的 LED 灯珠，接线端子无正负 极区分灯珠内置保护电阻，不需外接。 Using AC and DC universal LED lamp beads, the terminal has no positive and negative poles to distinguish the built-in protection resistance of the lamp beads, and does not need to be connected.
电路	

开关结构说明 /Switch structure description

型式 Type	示意图 Schematic diagram	符号 Symbol
C		

引脚说明 /Pin description

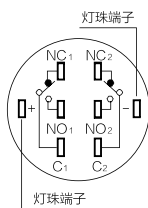

最多可配置两组开关。

C、NO、NC 和 C、NO、NC 分别为一组开关；C 脚为公用脚，NO 脚为常开脚，NC 脚为常闭脚；+、- 脚为灯珠引脚，常规灯珠配置无正负极区分。灯珠与开关相对独立，可通过开关或外围电路控制灯珠状态。

Up to two sets of switches can be configured.

C, NO, NC and C, NO, NC are a set of switches; C foot is common foot, NO foot is normally open foot, NC foot is normally closed foot; +, - pins are lamp bead pins, and conventional lamp bead configuration has no positive and negative polar distinction. The lamp beads are relatively independent of the switch, and the lamp bead status can be controlled by the switch or peripheral circuit. Lamp bead terminals

性能特征 /Performance characteristics

产品规格 Product specifications	HJ □ □ A- □ ■ / □ / Q	机械寿命 Mechanical life	20 万次以上 More than 200,000 times		
绝缘强度 Dielectric strength	1500VAC	电气寿命 Electrical life	10 万次以上 More than 100,000 times		
绝缘电阻 Insulation resistance	≥ 1000MΩ	面板厚度 Panel thickness	1~10mm		
接触电阻 Contact resistance	≤ 50mΩ	螺母扭矩 Nut torque	5~14Nm		
开关规格 Switch specifications	3A/250V	操作压力 Operating pressure	3N~5N		
尾部配置 Bottom configuration	接线插片 (2.8×9mm) Wiring pins (2.8×9mm)	操作行程 Operation travel	约 3.1mm Approx. 3.1mm		
头部形状 Head shape	高平头 / 平头 High flat head/flat head	防护等级 Protection level	IP65 IK09		
环境温度 Ambient temperature	- 20°C ~+55°C				
材料 Material	触点 Contact	纯银镀金 Sterling silver gilded	带灯部分参数 LED parameter	灯珠类型 LED type	双向 LED 灯珠 (交直流通用) Two way LED beads (AC and DC universal)
	按键 Button	不锈钢 / 黄铜镀铬 / 铝 (氧化) Stainless steel / Chrome plated brass / aluminum (oxidized)		额定电压 Ue Rated voltage Ue	3V / 6V / 12V / 24V / 36V / 48V / 110V / 220V
	外壳 Housing	不锈钢 / 黄铜镀铬 / 铝 (氧化) Stainless steel / Chrome plated brass / aluminum (oxidized)		灯珠颜色 LED color	R Y G B W
	基座 Pedestal	PBT		灯珠寿命 LED life	40000 小时 40,000 hours
RoHS	可定制 Customizable				

金属按钮开关 /Metal push button switch



外形尺寸 /Outline size

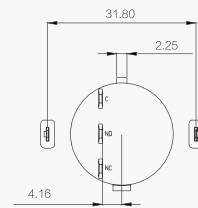
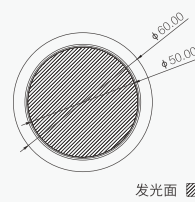
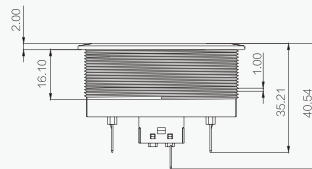
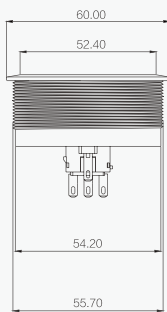

注：可选按钮开孔直径 $\phi 56$ mm
Note: Optional button opening diameter $\phi 56$ mm



B SERIES

B 系列按钮开关

B series push button switch

金属外壳，防止使用过程中各种撞击产生的开关失效现象。
按钮表面可订制各种图案以区分开关功能。
较短的体积可满足更狭小的安装空间。

Metal shell to prevent switch failure caused by various impacts during use.
The button surface can be customized with various patterns to distinguish the switch function.
The shorter volume allows for a smaller installation space.



抗震耐摔
shock-resistant



防水防尘
Waterproof and dustproof



安全实用
Safe and practical



品质保证
Quality assurance

型号说明 / Model description

企业代号 Business code	外壳材质 Housing material	安装孔尺寸 Mounting hole size		系列号 Serial number	触点结构 Contact structure	操作类型 Operation mode	头部形状 Head shape	接线类型 Wiring type				
H	JU	铜镀镍 Nickel-plated brass	16	Φ16mm	B	10	1NO	无字母代表自复 No letters represent Momentary	Q	球形 Spherical	Q	焊接脚 Welding pins
	JA	铝氧化 Aluminum oxide	19	Φ19mm					P	平头 Flat head	M	接线柱 Terminal
			22	Φ22mm					T	高平头 High flat head		

注：请仔细阅读产品具体说明后，根据不同符号在该表中选取相应代号。

定制特殊图案请与销售人员沟通确认。

外壳材料：黄铜镀铬、黄铜镀镍、不锈钢、铝氧化（彩色），下单请注明外壳材料，默认为黄铜镀铬外壳。

Note: Please read the specific description of the product carefully, and select the corresponding code in the table according to different symbols.

Customize special patterns, please communicate with sales staff to confirm.

Shell material: Chrome plated brass, brass nickel plated, stainless steel, aluminum oxidation (color), please indicate the shell material when placing an order, the default is Chrome plated brass shell.

概述 / Summary

安装孔尺寸 Mounting hole size	Φ16mm、19mm、22mm
开关额定值 Switch rating	2A/36V
开关组合 Switch combinations	1NO
操作类型 Operation mode	自复式 Momentary
头部形状 Head shape	球形 / 平圆形 / 高平圆形 Spherical/Flat head/ High flat head
外壳材料 Housing material	不锈钢 / 黄铜（镀铬或镀金）/ 铝（氧化）Stainless steel/Brass (chrome or gold plated)/Aluminum (oxidized)
防护等级 Protection level	BJ □ 16B(IP65) BJ □ 19B、BJ □ 22B(IP65/IP67) IK09
壳体颜色 housing color	R Y G B W BL
头部颜色 button color	R Y G B W BL

性能特征 / Performance characteristics

产品规格 Product specifications	HJ □ 16B- △ / △ / △	环境温度 Ambient temperature	- 20℃ ~ +55℃
头部形状 Head shape	球形 / 平圆形 / 高平圆形 Spherical/flat round/high flat round	机械寿命 Mechanical life	100 万次以上
尾部配置 Bottom configuration	接线柱 / 焊接脚 Binding posts/welding pins	电气寿命 Electrical life	20 万次以上 More than 200,000 times
开关规格 Switch specifications	2A/36VDC	面板厚度 Panel thickness	1~6mm
接触电阻 Contact resistance	≤ 50mΩ	螺母扭矩 Nut torque	5~14Nm
绝缘电阻 Insulation resistance	≥ 1000MΩ	操作压力 Operating pressure	约 4N About 4N
绝缘强度 Dielectric strength	1500VAC	操作行程 Operation travel	约 1.5mm About 1.5mm
RoHS	可定制 Customizable		
基座 Pedestal	PBT		
材料 Material	触点 Contact	银合金 Silver alloy	
	按钮 Button	不锈钢 / 铝（氧化）Stainless steel/Aluminum (oxidized)	
	外壳 Housing	不锈钢 / 黄铜（镀镍）/ 铝（氧化）Stainless steel/Brass (nickel-plated)/Aluminum (oxidized)	

金属按钮开关 /Metal push button switch



φ16

HJ □ 16B/Q/M



φ16

HJ □ 16B/P/M



φ16

HJ □ 16B/T/M



φ16

HJ □ 16B/Q/S



φ16

HJ □ 16B/P/S



φ16

HJ □ 16B/T/S



φ19

HJ □ 19B/Q/M



φ19

HJ □ 19B/P/M



φ19

HJ □ 19B/T/M

外形尺寸 /Outline size

*HJ □ 16B

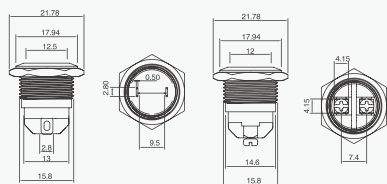

*HJ □ 19B

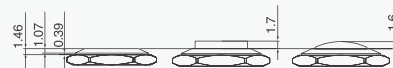
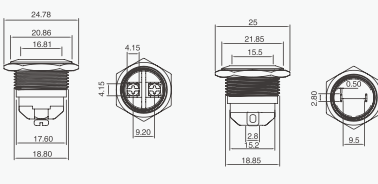

注: * 可选按钮开孔直径 φ16、19mm

Note: * Optional button opening diameter φ16、19mm

金属按钮开关 /Metal push button switch



外形尺寸 /Outline size

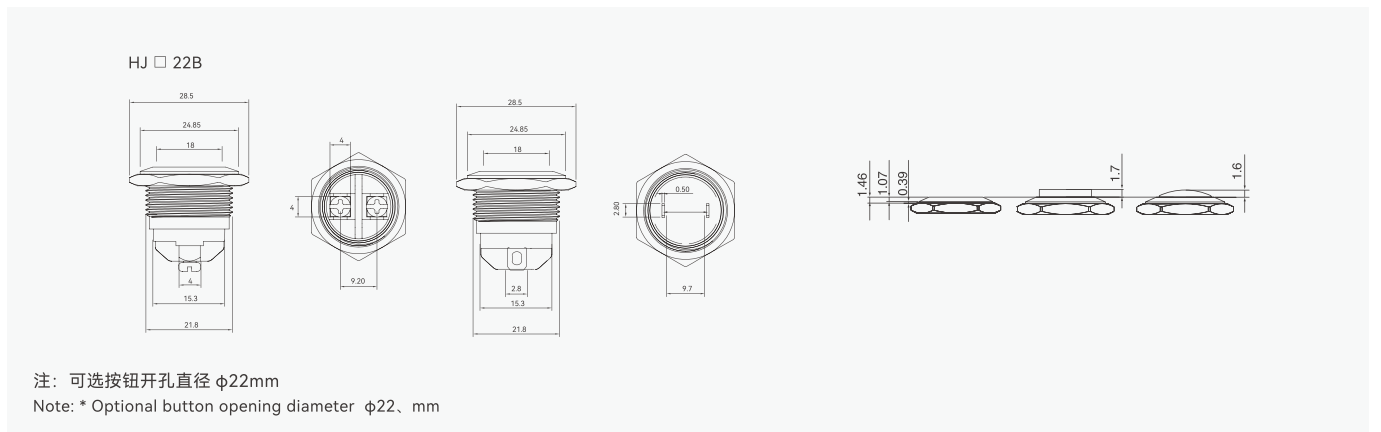

金属按钮开关 /Metal button



φ16

HJ □ 19B/Q/S



φ19

HJ □ 19B/P/S



φ22

HJ □ 19B/T/S



φ22

HJ □ 22B/Q/M

更多产品信息请详询本公司!

For more product information, please contact our company!

外形尺寸 /Outline size

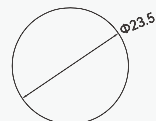
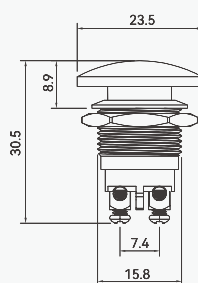
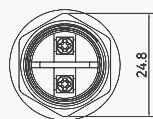
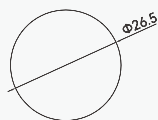
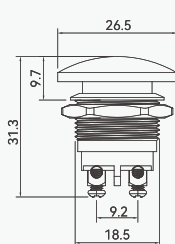
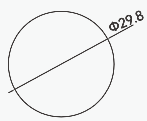
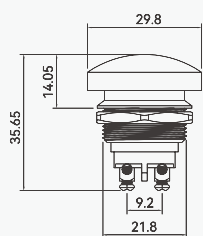

注: 可选按钮开孔直径 φ16、19、22mm

Note: * Optional button opening diameter φ16、19、22mm



12C SERIES

12C 系列按钮开关

12C series push button switch

防水 IP65/IP67，可直接在户外场景使用。
按钮表面可订制各种图案以区分开关功能。
短小的体积可满足更狭小的安装空间。

Waterproof IP65/IP67, can be used directly in outdoor scenes.

The button surface can be customized with various patterns to distinguish the switch function.

The short volume can meet the narrower installation space.



抗震耐摔
shock-resistant



防水防尘
Waterproof and dustproof



安全实用
Safe and practical



品质保证
Quality assurance

型号说明 / Model description

企业代号 Business code	外壳材质 Housing material	安装孔尺寸 Mounting hole size		系列号 Serial number	触点结构 Contact structure		操作类型 Operation mode		带灯类型 With LED		头部形状 Head shape		按键颜色 button color		接线类型 Wiring type		带灯颜色 LED color		带灯部分电压 LED voltage
H	JU 铜镀镍 Nickel-plated brass	12	Φ12mm	C	10	1NO	Z 自锁 Latching	D 点灯 Dot	无 NO	球形 Spherical	R 红 Red	S 焊接脚 Welding pins	R 红 Red						AC/DC 3V
	JA 铝氧化 Aluminum oxide						无 自复 Momentary		T 高头 High Head	Customize special patterns, please communicate with sales staff to confirm.		G 绿 Green		G 绿 Green					AC/DC 6V
	JG 不锈钢 Stainless steel										Y 黄 Yellow		Y 黄 Yellow						AC/DC 12V
	L 塑料 Plastics										B 蓝 Blue		B 蓝 Blue						AC/DC 24V
											WT 白 White		WT 白 White						AC/DC 36V
																			AC/DC 48V
																			AC/DC 110V
																			AC/DC 220V

Other colors can be customized

注：请仔细阅读产品具体说明后，根据不同符号在该表中选取相应代号。

定制特殊图案请与销售人员沟通确认。

外壳材料：黄铜镀铬、黄铜镀镍、不锈钢、铝氧化（彩色），下单请注明外壳材料，默认为黄铜镀铬外壳。

Note: Please read the specific description of the product carefully, and select the corresponding code in the table according to different symbols.

Customize special patterns, please communicate with sales staff to confirm.

Shell material: Chrome plated brass, brass nickel plated, stainless steel, aluminum oxidation (color), please indicate the shell material when placing an order, the default is Chrome plated brass shell.

概述 / Summary

安装孔尺寸 Mounting hole size	Φ12mm
开关额定值 Switch rating	2A/36V
开关组合 Switch combinations	1NO
操作类型 Operation mode	自复式 / 自锁式 Momentary/Latching
带灯方式 With LED	LED/ 单点 LED/ Single point
防护等级 Protection level	IP65/IP67 IK08
头部颜色 Head color	R Y G B W BL
外壳材料 Housing material	不锈钢 / 铝（氧化） 黄铜镀镍 Stainless steel/Aluminum (oxidized)/brass plated nickel
头部材料 Head material	PC/ 不锈钢 / 黄铜镀铬 / 黄铜镀镍 PC/Stainless steel/Chrome plated brass/brass nickel plating
工作环境温度 Operating ambient temperature	-25°C ~+55°C（无冰冻）照明开关本体周围必须空气流通 -25° C~+55° C (no freezing) must be air circulation around the lighting switch body
工作环境湿度 Working environment humidity	45~85% RH(无结露) 45~85%RH (non-condensing)
接触电阻 Contact resistance	≤ 50mΩ
绝缘电阻 Insulation resistance	≥ 1000MΩ
最高耐压 Maximum withstand voltage	1500 伏，交流 50 赫兹, 5 秒 1500 volts, 50 Hz AC, 5 seconds
耐振动性 Vibration resistance	大于 10g More than 10g
耐冲击性 Impact resistance	50 赫兹，振幅约 1.2mm 50 Hz, amplitude about 1.2mm
焊锡热 Soldering heat	320°C时（或 30 瓦烙铁）不超过 2 秒 At 320° C (or 30 watts of soldering iron) no more than 2 seconds



开关结构说明 / Switch structure description

型式 Type	示意图 Schematic diagram	符号 Symbol
C		

说明：具有两个端子的双断点慢动触头开关。

Description: Double break slow moving contact switch with two terminals.

性能特征 / Performance characteristics

产品规格 Product specifications	HJ □ 12C- △ / △ / △	机械寿命 Mechanical life	100 万次以上 More than 1,000,000 times
头部形状 Head shape	球形 / 高头 Spherical/high head	电气寿命 Electrical life	20 万次以上 More than 200,000 times
尾部配置 Bottom configuration	接线插片 (3.7x2.8mm) Wiring pins (3.7×2.8mm)	面板厚度 Panel thickness	1~5mm
开关规格 Switch specifications	2A/36V	螺母扭矩 Nut torque	5~14Nm
接触电阻 Contact resistance	≤ 50mΩ	操作压力 Operating pressure	约 4N About 4N
绝缘电阻 Insulation resistance	≥ 1000MΩ	操作行程 Operation travel	约 1.5mm About 1.5mm
绝缘强度 Dielectric strength	1500VAC	材料 Material	底座 Pedestal PA
环境温度 Ambient temperature	-20°C ~+55°C		外壳 Housing 不锈钢 / 黄铜 (镀铬) Stainless steel / brass (chrome plated)
防护等级 Protection level	IP65/IP67 IK08		按键 Button PC
RoHS	可定制 Customizable	触点 Contact point	镀金触点 Gold-plated contact
灯珠参数 LED specification	内置灯珠 Built-in lamp beads		
	灯珠颜色 LED color		
	额定电流 Ie Rated current Ie	3~48V 约 15mA 110~220V 约 2mA 3~48V about 15mA 110~220V about 2mA	
	额定电压 Ue Rated voltage Ue	3V/6V/12V/24V/36V/ 48V/110V/220V	
	灯珠寿命 LED life	40000 小时 40,000 hours	

注：如需单向直流 LED 灯珠可定做；其他电压规格可按要求定做。

Note: If unidirectional DC LED lamp beads are required, they can be customized; Other voltage specifications can be customized as required.